

GRID SCALE FACTOR: 1.0000064
GRID DIST. DIVIDED BY GRID
SCALE FACTOR = GROUND DIST



LAKE MICHIGAN

CHARLES MEARS STATE PARK

PENTWATER LAKE

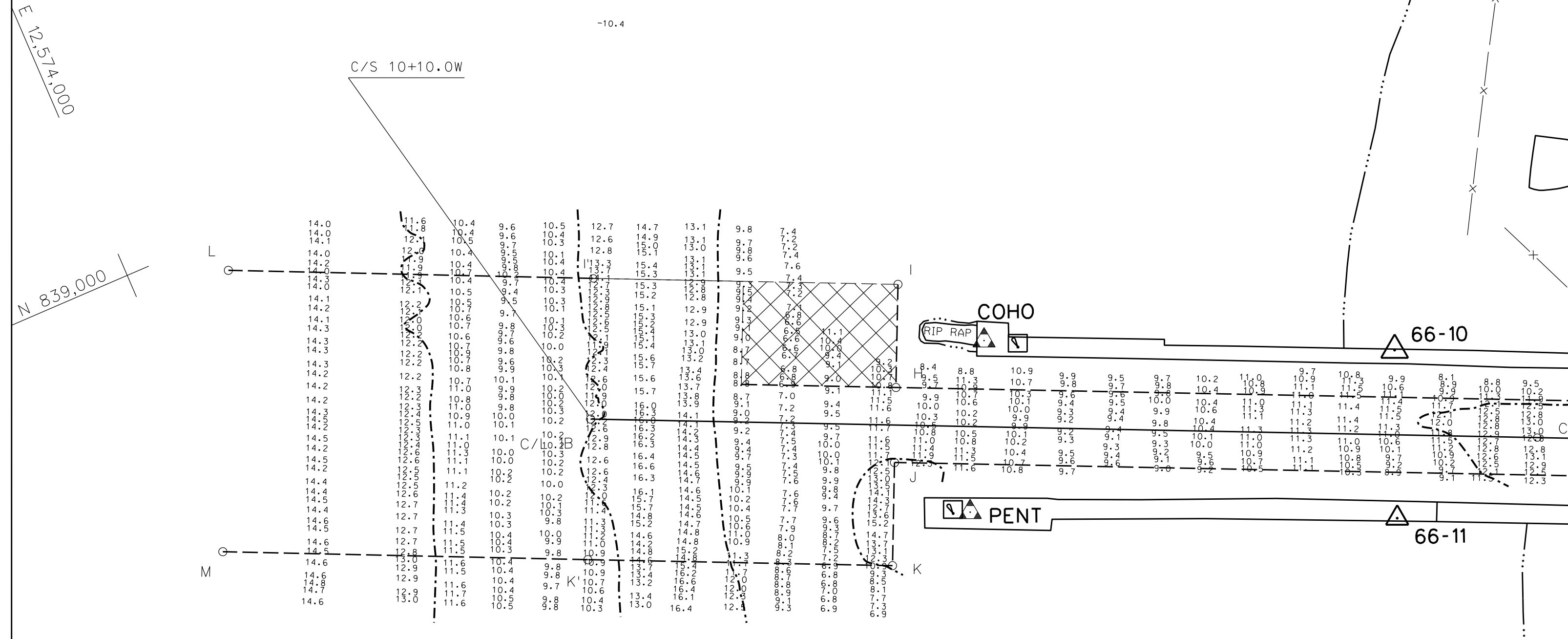

CHANNEL LINE TURNING POINTS		
STATION NUMBER	COORDINATES	
	NORTH	EAST
D	837,685.18	12,576,687.56
E	837,575.96	12,576,637.86
F	837,867.30	12,576,239.10
G	837,794.48	12,576,205.97
H	838,565.25	12,574,705.46
I	838,665.37	12,574,751.01
J	838,800.00	12,574,455.21
K	838,492.44	12,574,672.32
L	838,392.32	12,574,626.75
M	838,526.94	12,574,330.95
N	838,362.20	12,574,101.18
O	838,689.14	12,573,976.91

CENTERLINE		
STATION NUMBER	COORDINATES	
	NORTH	EAST
C/L B	838,663.47	12,574,393.08
C/L D	838,245.11	12,575,312.35
C/L W	837,630.56	12,576,662.71

SURVEYED ON: 20 MARCH 2012
POSITIONING METHOD: DGPS, USING C.G. BEACON CORRECTIONS
VESSEL: LAUNCH 3033

PROJECT DEPTH 16.0 FT.
MAINTAINED DEPTH 12.0 FT.
CHANNEL LIMITS SHOWN THUS: - - - - -
12 FT. CONTOUR SHOWN THUS: - - - - -

NO DREDGING AREA SHOWN THUS: [Cross-hatched symbol]

ALL SOUNDINGS ARE REFERENCED TO I.G.L.D. 1985 FOR LAKE MICHIGAN, ELEVATION 577.5 FT. ABOVE MEAN SEA LEVEL AT RIMOUSKI, QUEBEC. HYDRAULIC CORRECTOR OF 0.3 FT. APPLIED.
GRID SYSTEM BASED ON LAMBERT PROJECTION, MICHIGAN STATE PLANE COORDINATE SYSTEM, SOUTH ZONE (2113) 1983 NORTH AMERICAN DATUM, U.S. SURVEY FOOT.

THE INFORMATION DEPICTED ON THIS MAP REPRESENTS THE RESULTS OF SURVEYS MADE ON THE DATES INDICATED AND CAN ONLY BE CONSIDERED AS INDICATING THE GENERAL CONDITIONS EXISTING AT THAT TIME.

DATE OF PHOTOGRAPHY
14 APRIL 1994

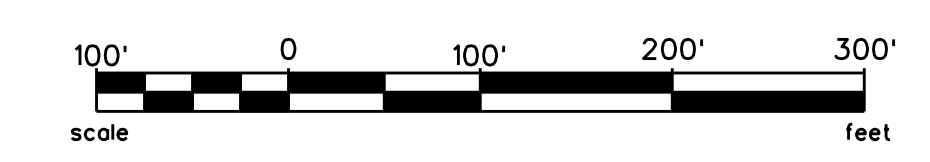

NO.	DATE	REVISION	BY

U.S. ARMY ENGINEER DISTRICT, DETROIT
CORPS OF ENGINEERS
DETROIT, MICHIGAN

PENTWATER HARBOR, MICHIGAN
CONDITION OF CHANNEL
MARCH 2012
GRAND HAVEN AREA OFFICE

DRAWN BY	
DESIGNED BY	
CHECKED BY	
REVIEWED	
SUBMITTED	APPROVAL RECOMMENDED
CHEF, BRIG. OPERS. SECTION	CHEF, OPS. BRANCH
APPROVED	
P.E.	
CHEF, CONST. & OPNS. DIVISION	

SCALE 1" = 100'
DATE
CADD FILENAME: pw0312.dgn
DRAWING NUMBER
SHEET 1 OF 1